

Part number description :

10134259-XXXLF

- ▶ LF: Lead Free, RoHs compliant, see note
- ▶ XXX : Color ref or/and version

PN	Colour	Version
10134259-001LF	grey	

TECHNICAL DATA / DIMENSIONS

Dimensions	
Width mm	1.5
Length mm	44.0
Height mm	35.0

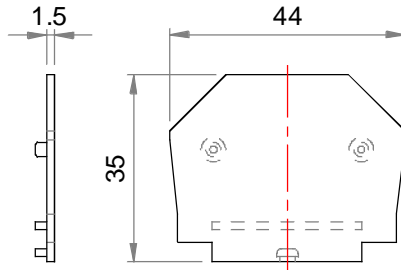

Note : THIS PRODUCT MEETS EUROPEAN UNION DIRECTIVES AND OTHER COUNTRY REGULATIONS AS PER GS-47-0004

ACCESSORIES

Item	Description
Additional items	
10134250-001LF	SCREW Terminal Block 2,5 – All colours
10134251-001LF	SCREW Terminal Block 4 – All colours
10134252-001LF	SCREW Terminal Block 5 – All colours

spec ref		dir	Aymeric Soudy	11-06-2015	projection		size	A3	scale	1:1												
tolerance std		eng	Aymeric Soudy	11-06-2015	mm		ecn no															
ISO 406		TOLERANCES UNLESS OTHERWISE SPECIFIED					<table border="1"> <tr> <td>linear</td> <td>0.X</td> <td>± 0.3</td> </tr> <tr> <td></td> <td>0.XX</td> <td>± 0.1</td> </tr> <tr> <td></td> <td>0.XXX</td> <td>± 0.05</td> </tr> <tr> <td>angular</td> <td>0°</td> <td>± 2°</td> </tr> </table>				linear	0.X	± 0.3		0.XX	± 0.1		0.XXX	± 0.05	angular	0°	± 2°
linear	0.X										± 0.3											
	0.XX	± 0.1																				
	0.XXX	± 0.05																				
angular	0°	± 2°																				
ISO 1101		appr	Aymeric Soudy	11-06-2015	product family	DIN Terminal Block		rel level														
surface ✓					title End Plate for SCREW Terminal Blocks 2,5-4		dwg no 10134259		rev A													
ISO 1302											www.fcicon		cat. no.	-	Product customer drawing	sheet 1 of 1						



Copyright FCI.