

NOTES:

1. Ⓢ REPRESENTS CRITICAL DIMENSION.
2. SHEAR TAILS TO DIMENSION SHOWN.
3. DO NOT CHECK, FOR CUSTOMER REFERENCE ONLY.
4. MAX CUT FLASH: .010 [.25] AWAY FROM PCB.
5. DIMENSIONS TO BE SYMMETRIC ABOUT CENTER LINE.
6. BURR ALLOWANCE: .003 [.08] MAX., AND .006 [.15] IF AWAY FROM THE PCB.
7. 7 POSITION PARTS AVAILABLE IN -TR ONLY.
8. MINIMUM CONTACT RETENTION: 7 OUNCES

DO NOT SCALE FROM THIS PRINT

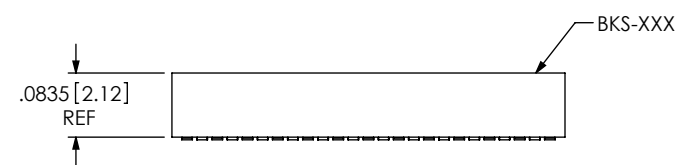
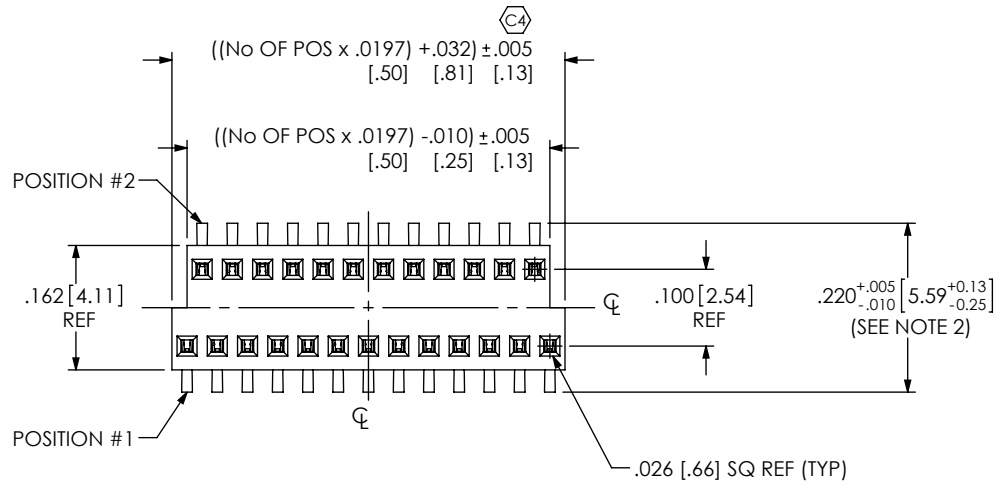
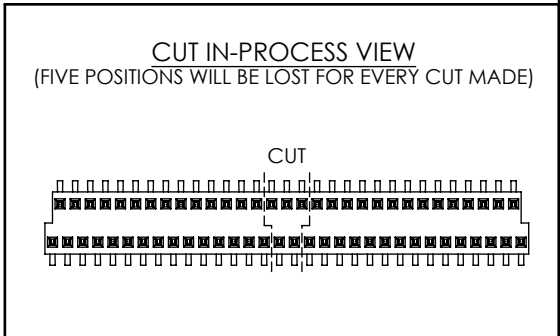
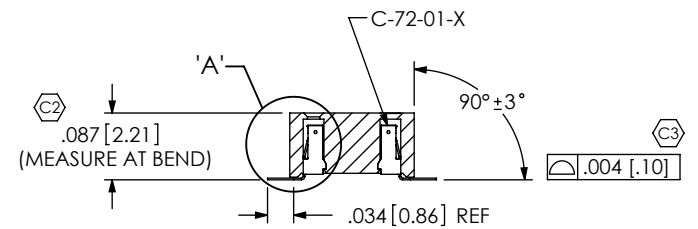
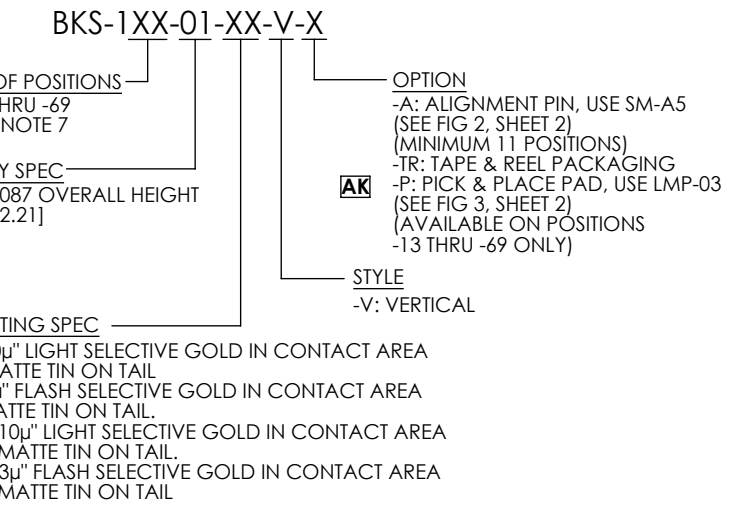
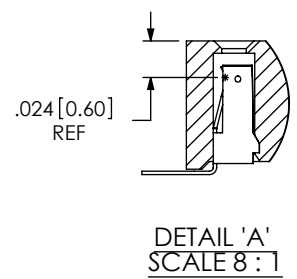
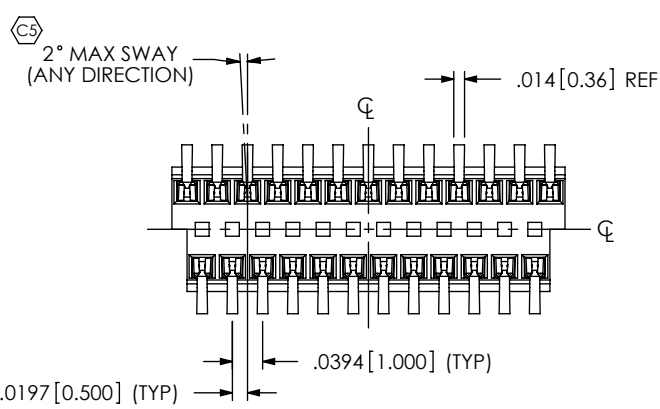

FIG 1



PATENT NUMBERS
5713755
5961339

<p>UNLESS OTHERWISE SPECIFIED, DIMENSIONS ARE IN INCHES.</p> <p>TOLERANCES ARE:</p> <p>DECIMALS ANGLES</p> <p>.X: ±.1 [2.54]</p> <p>.XX: ±.01 [.25]</p> <p>.XXX: ±.005 [1.27]</p> <p>.XXXX: ±.0020 [0.51]</p>	<p>PROPRIETARY NOTE</p> <p>THIS DOCUMENT CONTAINS INFORMATION CONFIDENTIAL AND PROPRIETARY TO SAMTEC, INC. AND SHALL NOT BE REPRODUCED OR TRANSFERRED TO OTHER DOCUMENTS OR DISCLOSED TO OTHERS OR USED FOR ANY PURPOSE OTHER THAN THAT WHICH IT WAS OBTAINED WITHOUT THE EXPRESSED WRITTEN CONSENT OF SAMTEC, INC.</p>	<p>DESCRIPTION:</p> <p>STAGGERED 1MM C.L. SURFACE MOUNT SOCKET</p>
		<p>DWG. NO.</p> <p>BKS-1XX-01-XX-V-X</p>
<p>MATERIAL: DO NOT SCALE DRAWING SHEET SCALE: 2:1</p> <p>INSULATOR: LCP, UL 94 VO, COLOR: BLACK</p> <p>TERMINAL: PHOS BRONZE</p>		<p>BY: BRATCHER 03/27/1995</p>
<p>F:\DWG\MISC\MKTG\BKS-1XX-01-XX-V-X-MKT.SLDDRW</p>		<p>SHEET 1 OF 2</p>

-TR: TAPE AND REEL

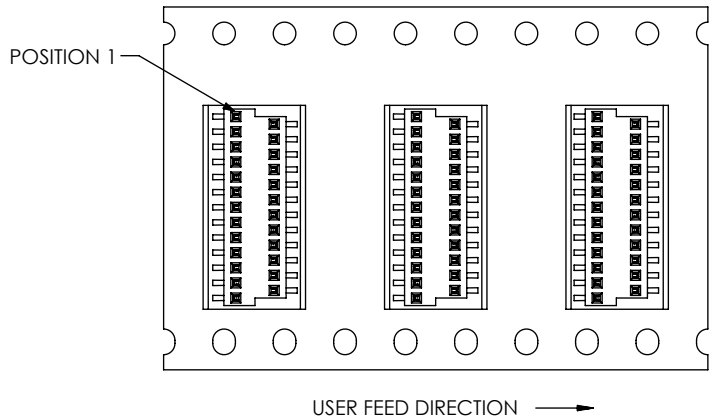

FIG 4
(SCALE: 2:1)

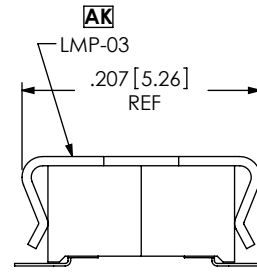
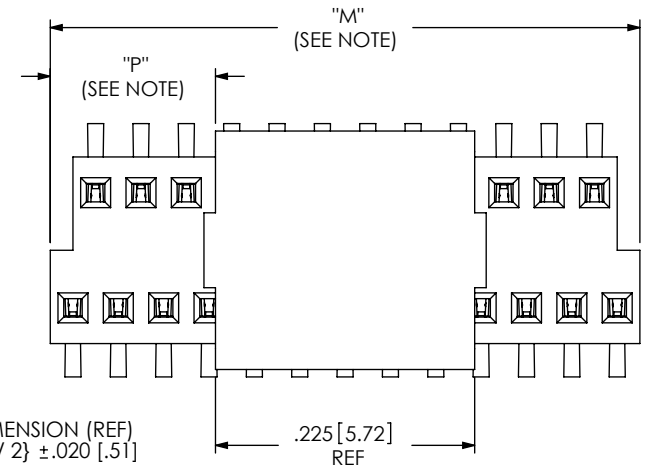

FIG 3
-P: PICK & PLACE PAD

NOTE: "M" = USED MEASURED DIMENSION (REF)
"P" = $\{("M" - .2386 [6.060]) / 2\} \pm .020 [.51]$



-A: ALIGNMENT PIN OPTION

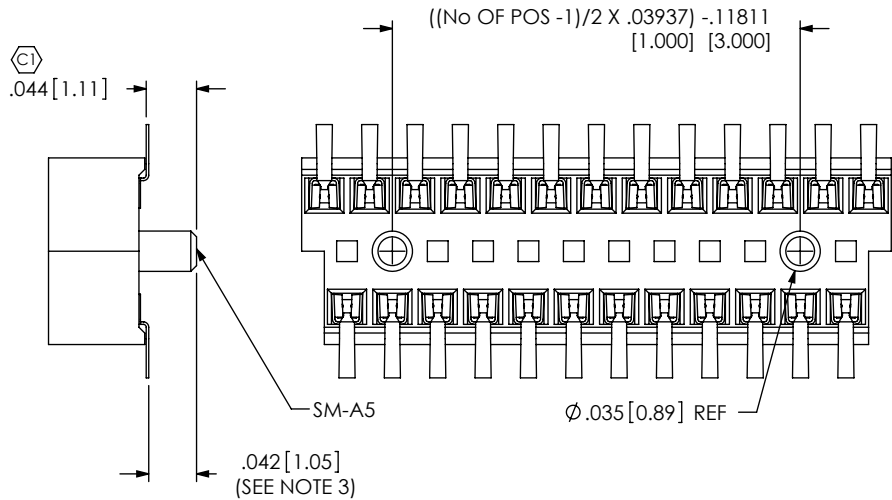
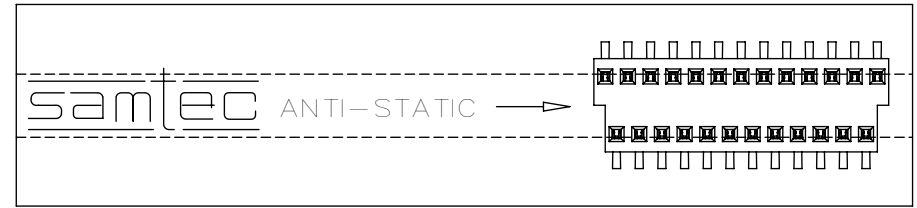
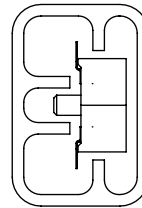
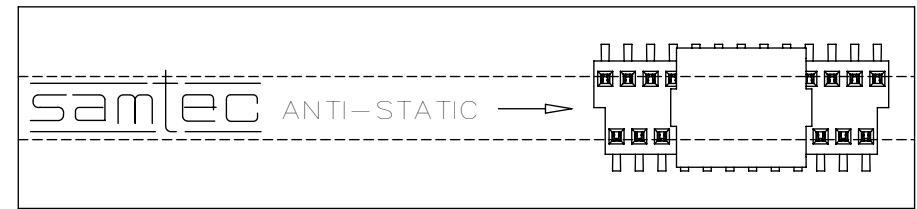
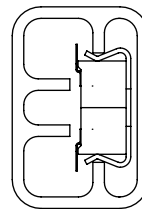

FIG 2



NOTE: PARTS ARE TO BE PACKAGED IN A PT-1-24-03-65 TUBE WITH TWO TP-12 PLUGS PER TUBE AND POS. 1 WITH ARROW.



NOTE: PARTS WITH PAD ARE TO BE PACKAGED IN A PT-1-24-03-65 TUBE WITH TWO TP-12 PLUGS PER TUBE AND POS. 1 WITH ARROW.

PACKAGING VIEW
(SCALE: 3:1)

PROPRIETARY NOTE
THIS DOCUMENT CONTAINS INFORMATION CONFIDENTIAL AND PROPRIETARY TO SAMTEC, INC. AND SHALL NOT BE REPRODUCED OR TRANSFERRED TO OTHER DOCUMENTS OR DISCLOSED TO OTHERS OR USED FOR ANY PURPOSE OTHER THAN THAT WHICH IT WAS OBTAINED WITHOUT THE EXPRESSED WRITTEN CONSENT OF SAMTEC, INC.

DO NOT SCALE DRAWING

SHEET SCALE: 8:1

samtec

520 PARK EAST BLVD, NEW ALBANY, IN 47150
PHONE: 812-944-6733 FAX: 812-948-5047
e-Mail info@SAMTEC.com code 55322

DESCRIPTION:
STAGGERED 1MM C.L. SURFACE MOUNT SOCKET

DWG. NO.
BKS-1XX-01-XX-V-X

BY: BRATCHER 03/27/1995 SHEET 2 OF 2